

AIRPORT ELEVATION 160 FEET

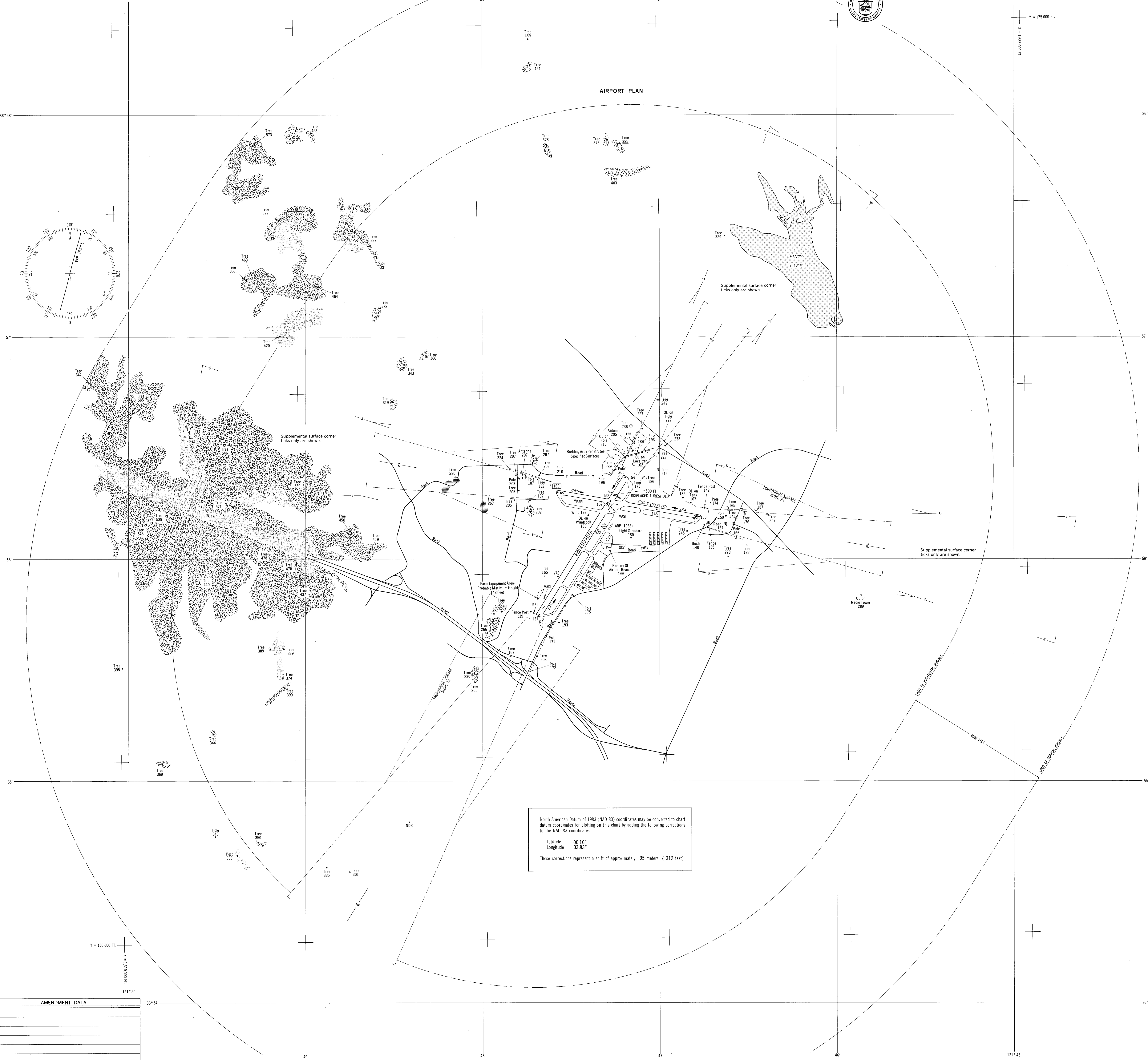

RUNWAY PLANS AND PROFILES

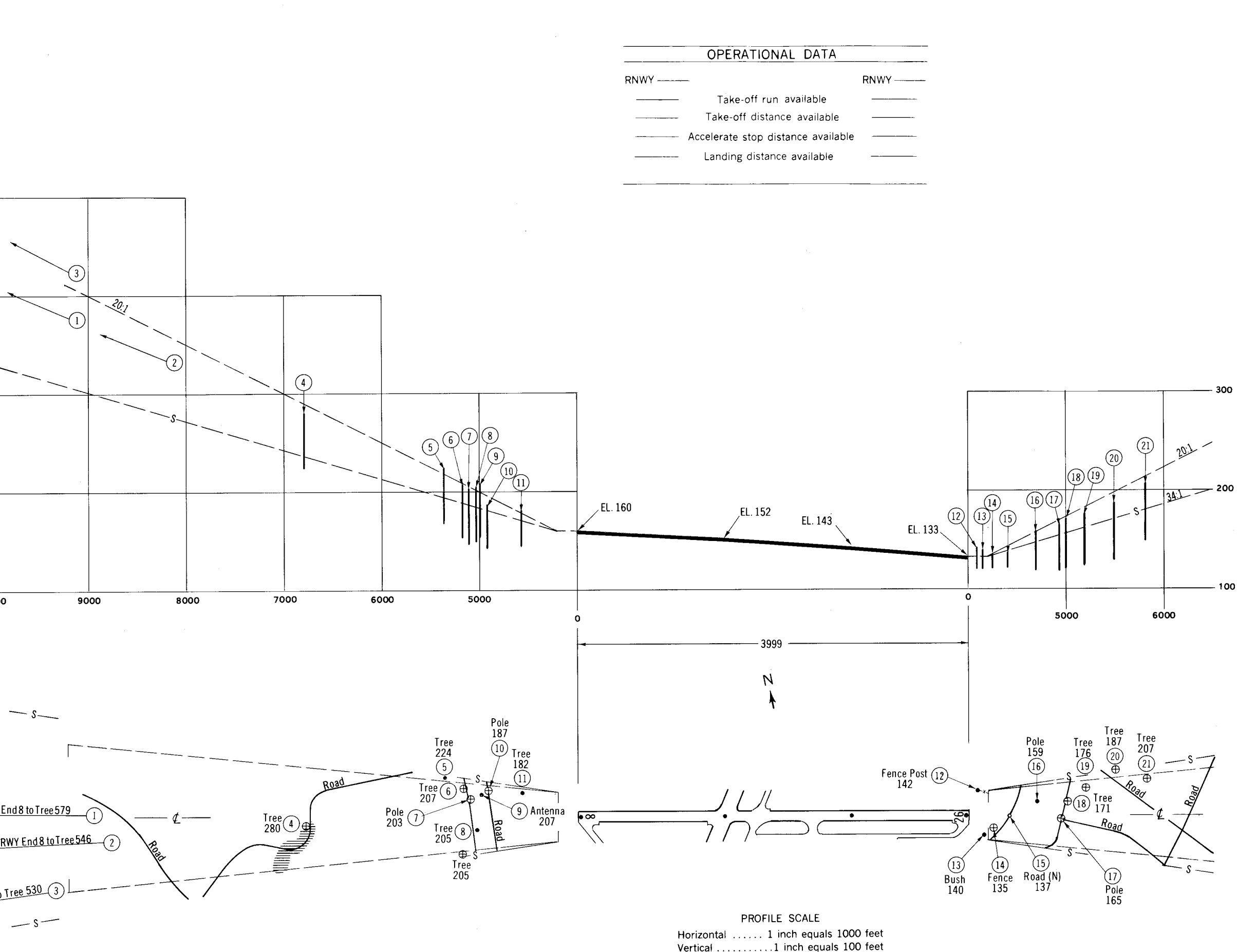
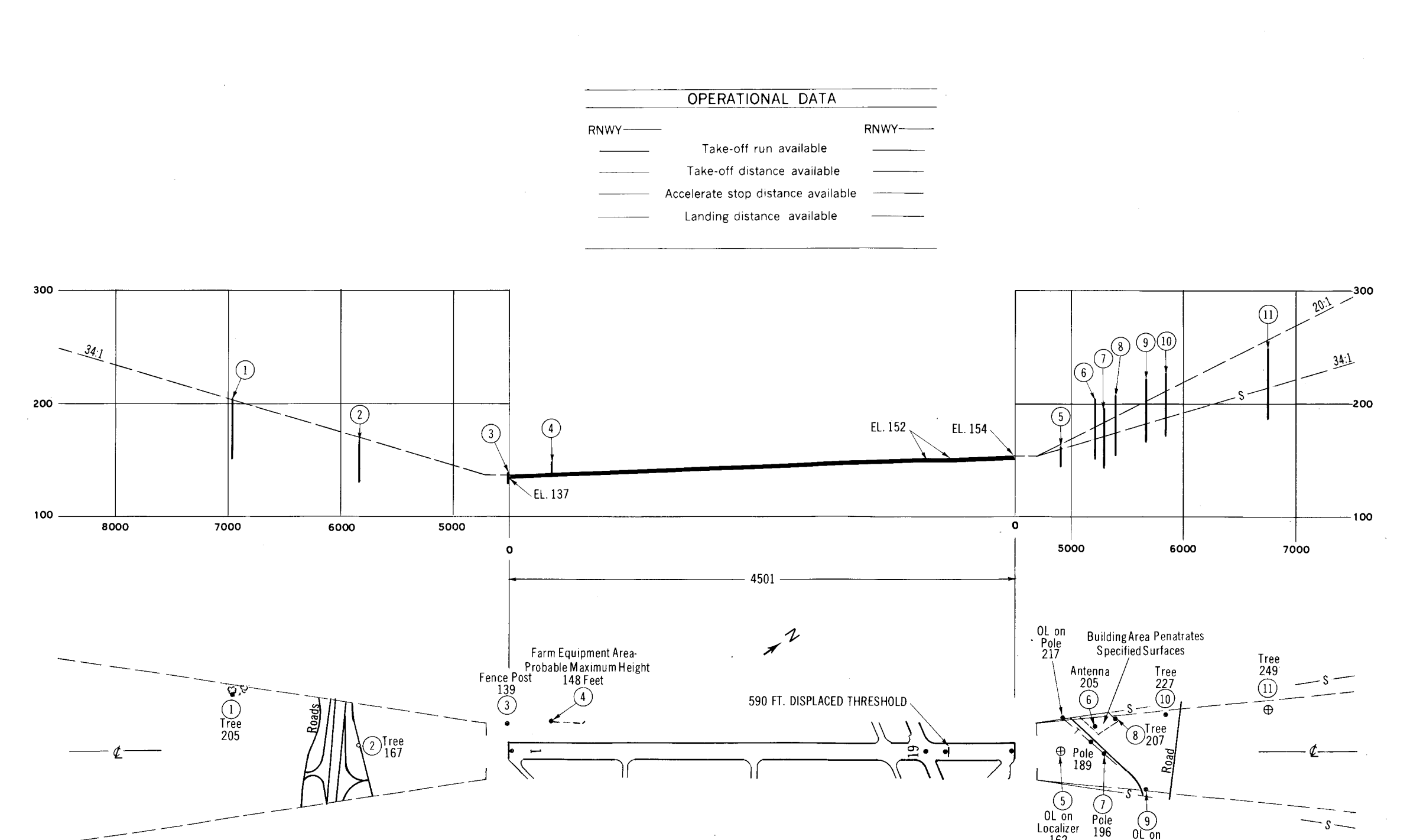

North American Datum of 1983 (NAD 83) coordinates may be converted to chart datum coordinates for plotting on this chart by adding the following corrections to the NAD 83 coordinates.

Latitude: $+00.16''$
 Longitude: $-03.83''$

These corrections represent a shift of approximately 95 meters (312 feet).

AIRPORT OBSTRUCTION CHART

The Airport Obstruction Chart (AOC) depicts Federal Aviation Regulations Part 77 (FAR 77) surfaces, a representation of objects that penetrate these surfaces, aircraft movement and apron areas, navigational aids, prominent airport buildings, and a selection of roads and other prominent details in the airport vicinity. Also included are tabulations of runway and other operational data.

DC content, format, and accuracy conform to the standards specified in FAR 77, "Object Affecting Navigable Airspace" and FAA Advisory Circulars - Airport Obstruction Chart and Related Products.

HORIZONTAL DATUM: North American Datum of 1927
 VERTICAL DATUM: National Geodetic Datum of 1929
 PROJECTION: Lambert Conformal Conic
 GRID SYSTEM: California State Grid Zone 3

- LEGEND**
- Airport Reference Point (ARP)
 - Official Airport Elevation
 - With elevation, object does not penetrate specified or supplemental surface
 - Without elevation, position only
 - Object penetrates specified surface
 - Wooded area penetrates specified surface
 - Ground area penetrates specified surface
 - Object penetrates supplemental surface only
 - Wooded area penetrates supplemental surface only
 - Ground area penetrates supplemental surface only
 - Water
 - Threshold lights
 - Supplemental surface
 - Feet above ground level
 - Interstate highway
 - Noninterstate highway
 - Obstruction Light or Obstruction Lighted

OPERATIONAL DATA

AIRPORT LOCATION POINT	LAT. 36° 56'	LONG. 121° 47'		
AIRPORT REFERENCE POINT	LAT. 36° 56' 06.786"	LONG. 121° 47' 18.835"		
RUNWAY	LATITUDE	LONGITUDE	TQZE	*GEODEIC AZIMUTH
1	36° 55' 44.676"	121° 47' 41.001"	149	212° 18' 58"
19	36° 55' 22.287"	121° 47' 11.364"	152	32° 19' 16"
19	36° 56' 17.354"	121° 47' 15.251"	152	32° 19' 16"
8	36° 56' 18.128"	121° 47' 34.834"	160	279° 49' 09"
26	36° 56' 11.382"	121° 46' 44.295"	154	99° 49' 38"

SPECIAL NOTES

Fifteen feet added to noninterstate road elevations
 Seventeen feet added to interstate road elevations
 Twenty three feet added to railroad track elevations
 Transitional surface slopes are 7:1 unless otherwise indicated
 Obstructing area limits are approximate
 Undertied elevations determined photographically not field checked

*Geodetic azimuth reckoned clockwise from south
 **Displaced threshold

AMENDMENT DATA

NO.	DATE	DESCRIPTION